



*** ALL TOILETS:**

- ALL TOILETS FLOOR TO BE FINISHED W/ SELECTED HOMOGENEOUS FLOOR TILES
- ALL TOILETS WALL TO BE FINISHED W/ SELECTED GLAZED CERAMIC WALL TILES UP TO CEILING HEIGHT ALL ROUND INTERNAL WALL

LEGENDS:

- 100mm # UPVC W.P
- 100mm # UPVC S.P
- 100mm # UPVC V.P
- 9 KG DRY POWDER FIRE EXTINGUISHER
- C/W MALL HUNG BRACKET
- COMBINATION SMOKE HEAT DETECTOR
- SMOKE DETECTOR
- 1 HOUR FIRE RATED DOOR
- EMERGENCY LIGHT
- 'KELUAR' SIGN

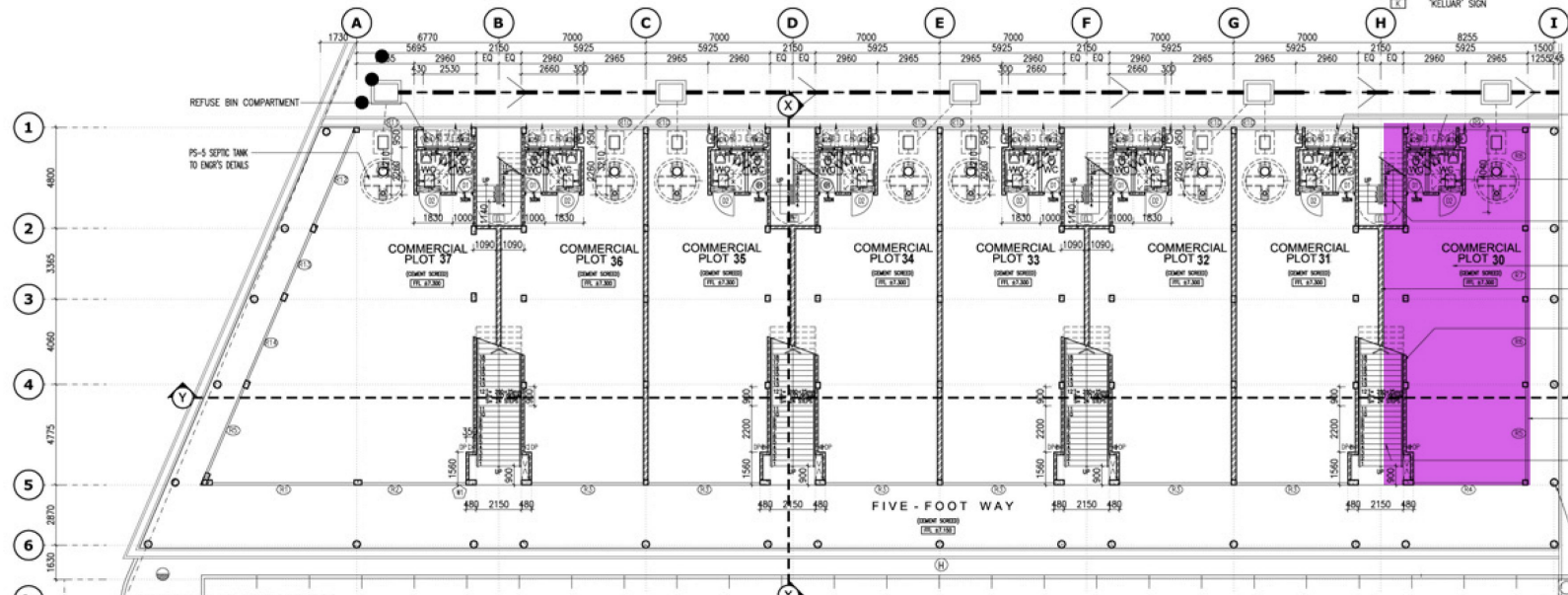

- ALL W.C.
- R.C. FLOOR SLAB SHALL BE WATERPROOFED AND EXTENDED UP 150mm MIN. TO ALL UPSIDES/WALL TO MANUF'S DETAIL AND SPECIFICATION TO PROVIDE 100mm # S.S. FLOOR TRAP.
- 750mm X 750mm TRAP DOOR
- STAIRCASE 2
- R.C. STAIRCASE TO ENGR'S DETAILS W/ 24 RSERS, R=177.08MM, GONG=25MM, T=20MM W/ 1000MM HIGH M.S. RAILING
- R.C. FLOOR SLAB TO ENGR'S DETAIL
- 230mm THK. BROOKNALL WITH CEMENT PLASTERED AND PAINTED FINISH ON BOTH SIDES
- 130mm THK. BROOKNALL WITH CEMENT PLASTERED AND PAINTED FINISH ON BOTH SIDES
- CJ ROLLER SHUTTER TO MANUF'S DETAIL
- STAIRCASE 1
- R.C. STAIRCASE TO ENGR'S DETAILS W/ 24 RSERS, R=177.08MM, GONG=25MM, T=20MM W/ 1000MM HIGH M.S. RAILING
- R.C. COLUMN TO ENGR'S DETAIL

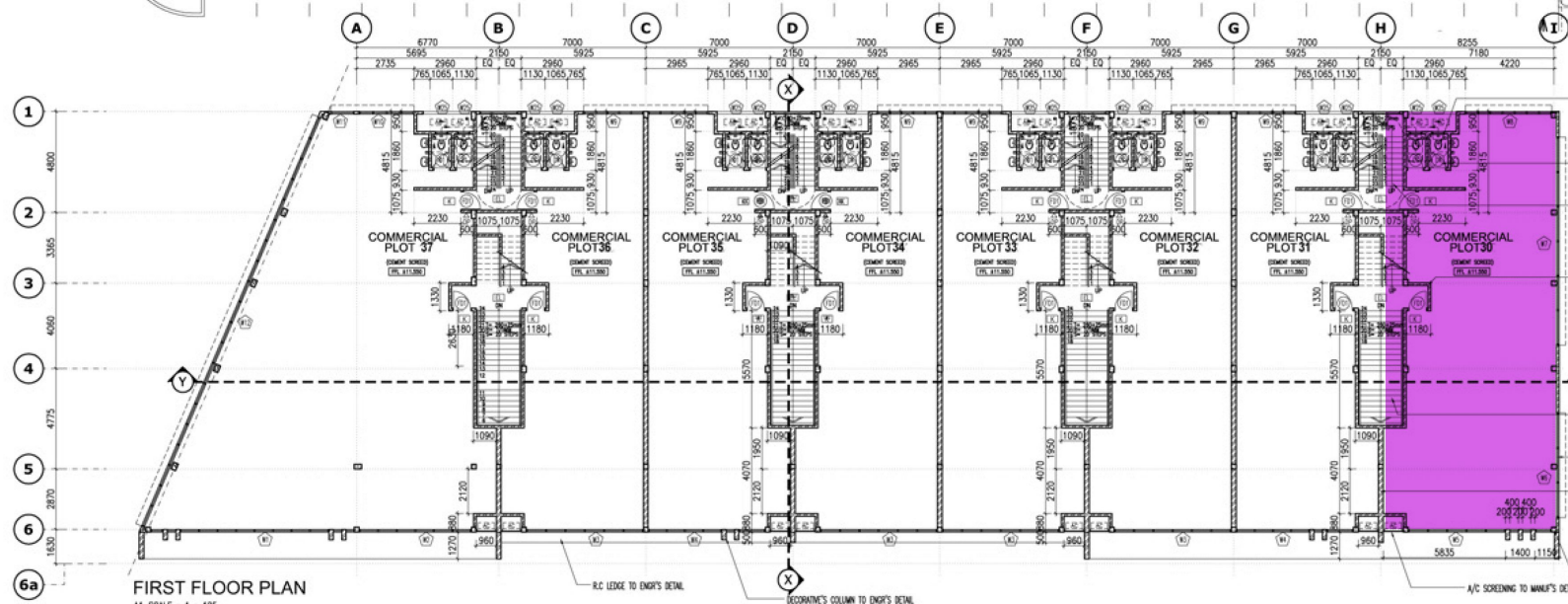

- ALL W.C.
- R.C. FLOOR SLAB SHALL BE WATERPROOFED AND EXTENDED UP 150mm MIN. TO ALL UPSIDES/WALL TO MANUF'S DETAIL AND SPECIFICATION TO PROVIDE 100mm # S.S. FLOOR TRAP.
- 750mm X 750mm TRAP DOOR
- STAIRCASE 2
- R.C. STAIRCASE TO ENGR'S DETAILS W/ 20 RSERS, R=175MM, GONG=25MM, T=20MM W/ 1000MM HIGH M.S. RAILING
- 130mm THK. BROOKNALL WITH CEMENT PLASTERED AND PAINTED FINISH ON BOTH SIDES
- NATURAL ANODIZED ALUMINUM FRAME OSCUREMENT WINDOW W/ 5mm THK. M.S.S. TINTED GLASS TO MANUF'S DETAIL
- 230mm THK. BROOKNALL WITH CEMENT PLASTERED AND PAINTED FINISH ON BOTH SIDES
- R.C. COLUMN TO ENGR'S DETAIL
- A/C SCREEDING TO MANUF'S DETAIL

